

S-5-V

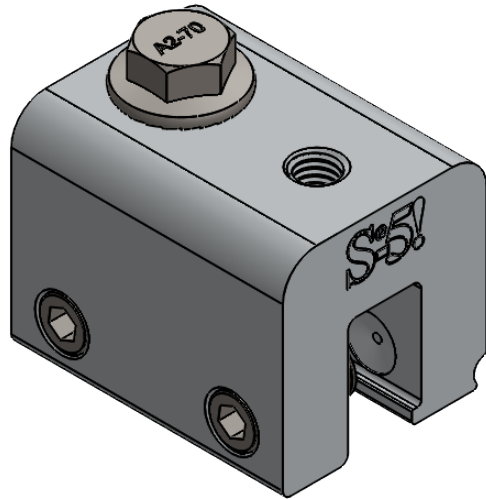

M8-1.25 Threaded Hole

Top

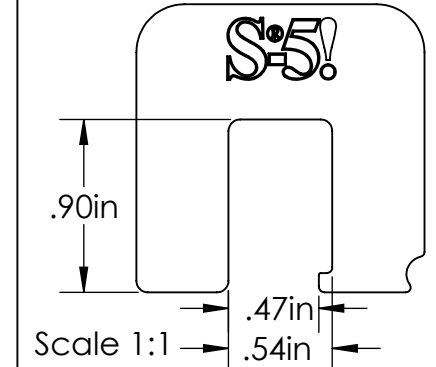
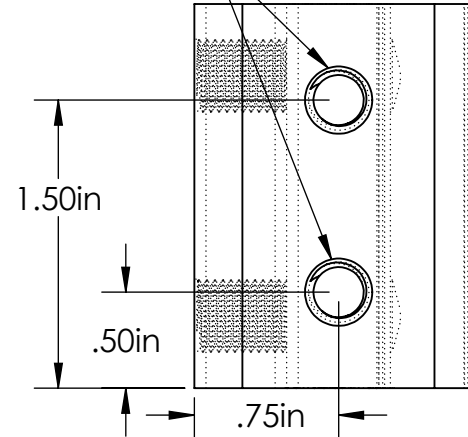

Back

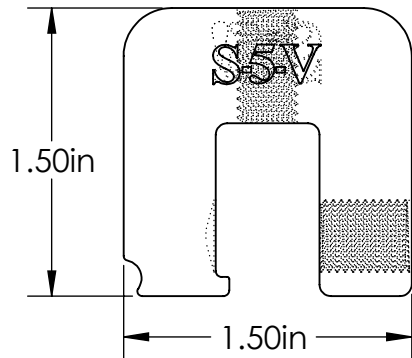

Left

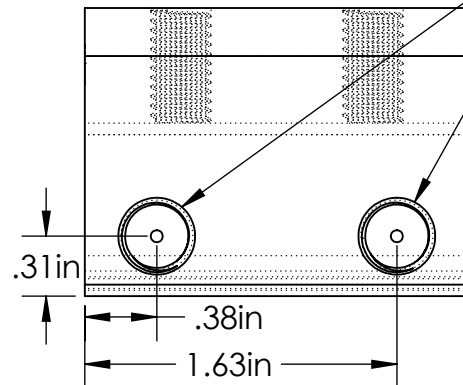

Front

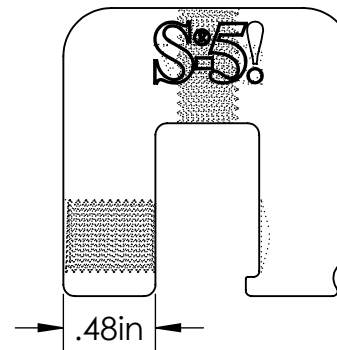

Right

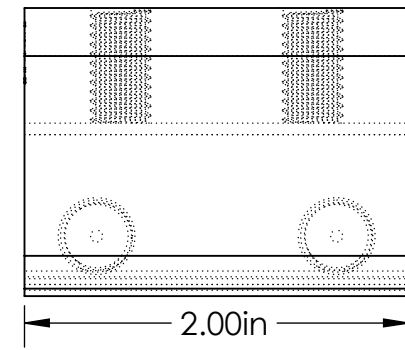

General Notes:

1. S-5-V Clamp
2. M8-1.25 SS Hex Flange Bolt (13mm Socket)
3. 3/8-24 SS Round Point Setscrew (3/16 Hex Drive)
4. Example roof

FOR STANDING SEAM SPECIFIC MECHANICAL LOAD TEST INFORMATION AND CLAMP INSTALLATION INFORMATION PLEASE VISIT: WWW.S-5.COM

MATERIAL: 6061 T6 Al	 METAL ROOF INNOVATIONS, LTD. 8655 TABLE BUTTE RD COLORADO SPRINGS, CO 80908 719-495-0518 719-495-0045(FAX)		
EST ASSEMBLY WEIGHT: 0.382 lbs	TITLE S-5-V		
SUPPLIED HARDWARE: M8-1.25 x 16 mm Bolt (2x) 3/8-24 x .800" Setscrews	DRAWING NO. V07-A-0-D	DRAWN BY Kati Kadakas	DATE 4/11/2016
SCALE: 1:1 EST. WEIGHTS: Clamp: 0.313 lbs Setscrew: 0.0170 lbs Bolt: 0.0345 lbs			

S-5!® PRODUCTS ARE PROTECTED BY MULTIPLE U.S. AND FOREIGN PATENTS.
VISIT OUR WEBSITE AT WWW.S-5.COM FOR COMPLETE INFORMATION ON PATENTS AND TRADEMARKS.