

# S-5!®

The Right Way!

The right way to attach almost anything to metal roofs!

## Installation Instructions

**S-5!® Warning!** Please use these products responsibly! Visit our website or contact your S-5! distributor for available load test results. The user and/or installer of these parts is responsible for all necessary engineering and design to ensure the VersaGard™ has been properly spaced and configured.

**Notice to S-5! users:** Due to the many variables involved with specific panel products, climates, snow melt phenomena, and job particulars, the manufacturer cannot and does not express any opinions as to the suitability of any S-5! assembly for any specific application and assumes no liability with respect thereto. S-5! products are tested for ultimate holding strength on various profile types and materials. This information is available from the S-5! website: [www.S-5.com](http://www.S-5.com).

These install instructions serve to illustrate the correct procedure for securing the VersaGard to a roof. Proper bracket layout and frequency will vary on a job specific basis and should be determined by a qualified professional. This document is an installation guide only and the photographs and drawings herein are for the purpose of illustrating installation, tools and techniques, not system designs. Information contained within is intended to apply to the document as a whole.

**The VersaGard™ is made for trapezoidal, exposed-fastened profiles.**

## Tools Needed

- Screw Gun\*
- Rag
- String Line
- Tape Measure

**\*For time saving tool recommendations contact S-5!**

VersaGard should be placed in the flat of the panel, between the ribs, and never straddling a striation. VersaGard must be mounted directly over and into the supporting structure of the roof, i.e. wood decking, wood or steel purlins, or trusses, NEVER into the metal roofing material alone. To accommodate various rib heights and to support one- or two-pipe snow retention preferences, VersaGard comes with two 1.05" holes (1" pipe not included). To support PV installation, the diagonal "slot" provides height flexibility.

To ensure brackets are installed in a straight line, install a single VersaBracket on each end of the roof at a measured consistent distance from the bottom edge of the roof. Use a string line between the two brackets. Mount the remaining VersaBracket along the string line, directly into the supporting structure of the roof.

## Use Proper Hardware

Only use appropriate screws, and hardware when attaching this product into the supporting structure.



Not Provided

**Metal to Metal Screw Specifications:** 1/4-14 Self Drilling Screw - 1-1/2" to 2-1/2" Length - 3/8" Hex Washer Head - Zinc/Aluminum Cap



Not Provided

**Metal to Wood Screw Specifications:** 1/4-14 Type 17-AB Milled Point - 1-1/2" to 2-1/2" Length - 3/8" Hex Washer Head - Zinc/Aluminum Cap

## To Install VersaGard™

1. Determine the location of the supporting structure of the roof. VersaGard can be installed parallel (for snow retention or PV installations) or perpendicular to the rib (for PV installations). When possible, secure VersaGard using all hole locations; when not possible, always use the two upslope hole locations. The only surface preparation necessary is to simply wipe away excess oil and debris.
2. Peel the release paper from the base, align, and apply to roof surface.
3. Secure the VersaGard by drilling screws through the pre-punched holes directly into the supporting structure of the roof. VersaGard is now ready for the attachment of PV rail or racking to the slotted hole or the placement of 1" pipe for snow retention.

**S-5!® Warning! Please use this product responsibly!**

Products are protected by multiple U.S. and foreign patents. For published data regarding holding strength, fastener torque, patents, and trademarks, visit the S-5! website at [www.S-5.com](http://www.S-5.com).

Copyright 2014, Metal Roof Innovations, Ltd. S-5! products are patent protected.

S-5! aggressively protects its patents, trademarks, and copyrights. Version 092514.

These instructions are for use by those experienced in the trade. Always follow appropriate safety precautions and use appropriate tools.

VGI-V1.0-0915

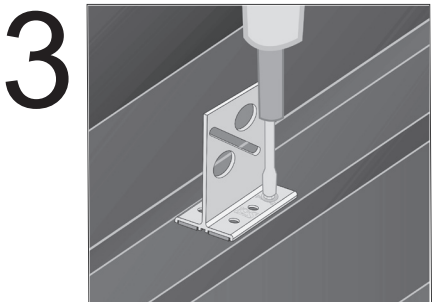
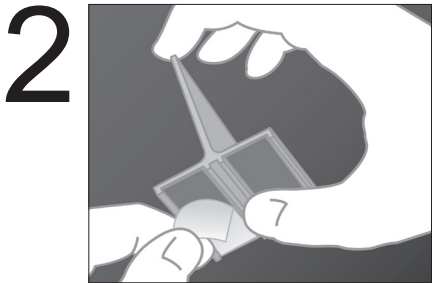
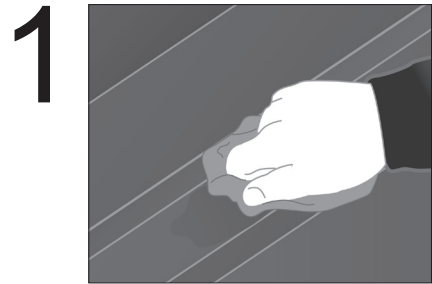

VersaGard™ Install

888-825-3432 | [www.S-5.com](http://www.S-5.com)